





# Inventco Water Door Closer

**The strong silent type.**

For sliding glass, security and screen doors

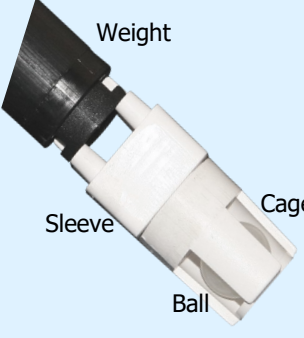
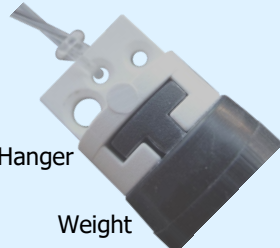
## Inventco DC Parts List - July 2020

<p><b>End Cap</b> Plastic dress piece visible at bottom of aluminium closer tube.</p>	<p><b>Code 02</b>  RR <b>\$6.00</b></p>	
<p><b>Bung</b> Rubber seal inside bottom of aluminium tube.</p>	<p><b>Code 01</b>  RR <b>\$7.00</b></p>	
<p><b>3S Valve assembly</b> With ball and cage and supplied as a kit that also includes (not shown) a set of three Speed Control Sleeves.</p>	<p><b>Code 09</b>  RR <b>\$21.00</b></p>	
<p><b>3S Upgrade Kit</b> Comprises: 2 Black Weights Pulley Box Kit Valve Assembly Kit</p>	<p><b>Code 12</b>  RR <b>\$92.00</b></p>	<p>The current 3S Door Closer version was released in October 2008. Earlier closers can be identified by white PVC covered weights with a key ring attachment for the nylon cord.</p>
<p><b>3S Weight Hanger Kit</b> Supplied as a kit with attached Nylon Cord.</p>	<p><b>Code 05</b>  RR <b>\$7.00</b></p>	
<p><b>3S Speed Control Sleeves</b> Set of three – one only shown</p>	<p>RR <b>\$7.00</b></p>	
<p><b>3S Pulley Wheel</b> With integral axle.</p>	<p><b>Code 03</b>  RR <b>\$7.00</b></p>	

**3S Pulley Box and Anchor Kit**  
With Pulley Wheel and Foam Pad. Supplied as a kit that also includes (not shown) Nylon Cord, Weight Hanger and Anchor Lug.

**Code 08**  
  
RR  
**\$25.00**

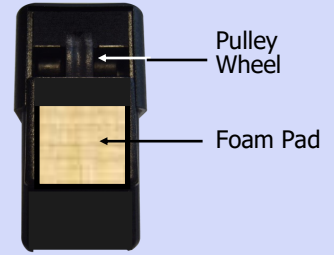

**3S Anchor Lug and Nylon Cord Kit**  
Supplied as a kit that includes (not shown) Nylon Cord and Weight Hanger.

**Code 06**  
  
RR  
**\$8.00**



**3S Heavy Duty Silver Weight**  
15% heavier than standard black weight.

**Code 11**  
  
RR  
**\$28.00**



**3S Black Weight**

**Code 10**  
  
RR  
**\$20.00**

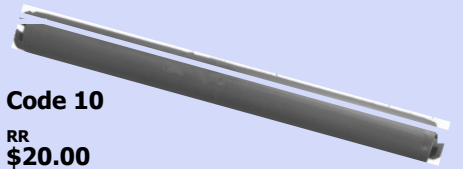

**Replacement Nylon Cord**  
Mono-filament nylon line.

**Code 04**  
  
RR  
**\$8.00**  
  
**(includes postage\*)**



**Please note: All parts are subject to postage charges\***

- If the door is latching too strongly/loudly with the standard two weights, always try fitting the Slow valve sleeve (S) to achieve a softer close rather than removing one of the weights.
- The weights are designed to be eased apart sideways. Extra care should be taken not to drop them when handling as the end connections can fracture if impacted. Such damage is not covered by warranty, nor is corrosion of the steel weight resulting from damage to the weight's plastic sheath.
- Guaranteed to close security and screen doors in good condition up to 1.5 x 2.4 metres in size. In the case of glass doors these can vary significantly in weight, and in friction between weather strip and track. Therefore it is suggested that the closer be clamped to the door (for convenience to the leading stile) and pre-tested prior to final fitment.

**Inventco Pty Ltd**  
ACN 109 598 978  
C/- Corp-Plan  
Level 9, 2 Corporate Ct, Bundall,  
Queensland Australia 4217

Ph: +61 7 5578 9015  
Web: [www.inventco.com](http://www.inventco.com)  
Email: [lesley@inventco.com](mailto:lesley@inventco.com)

